

UPCOM

The Faster. The Better.

www.upcom.com.tr

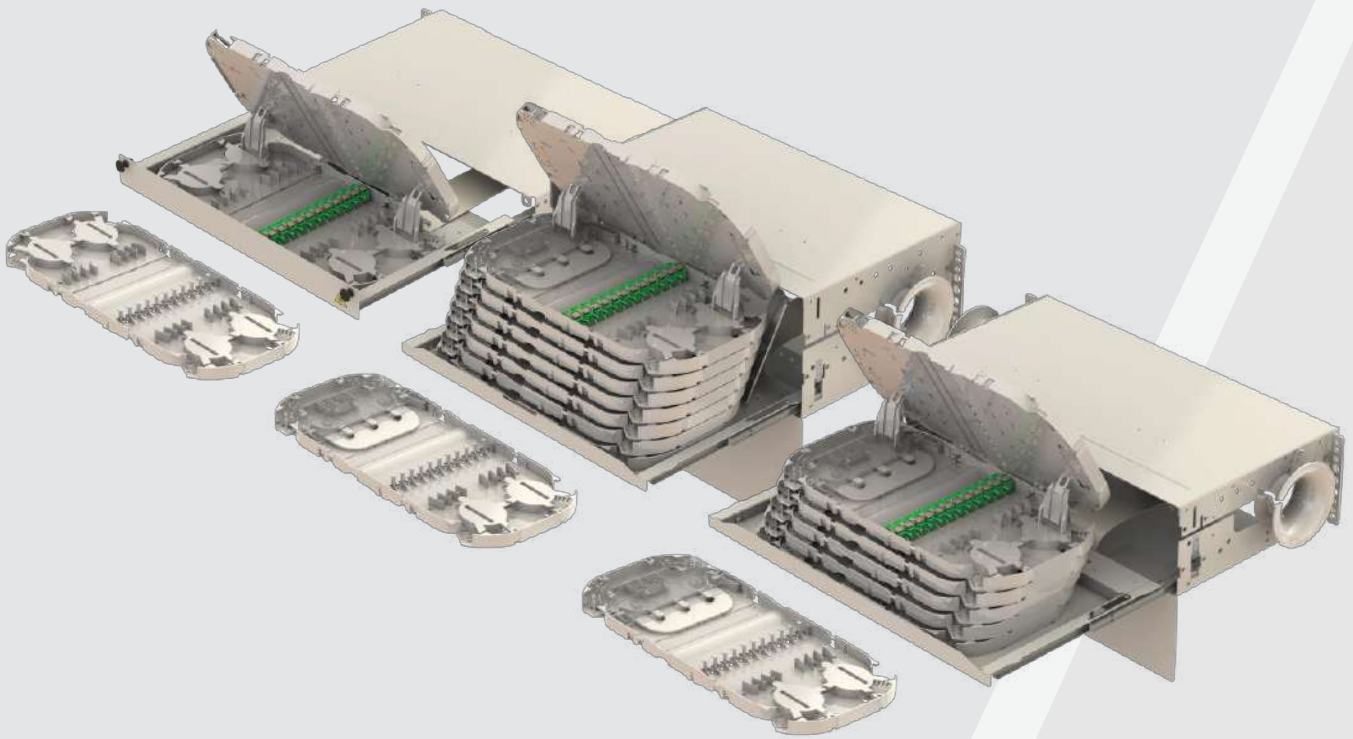

Fiber Management Shelves



www.upcom.com.tr

19" PP/SP 1U Fiber Management Shelves

Fiber Management Shelves are used to terminate and distribute optical fiber cables, termination box is ranging from 12 ports to 96 ports. They are convenient equipment to organize and connect the fiber optic links. It is suitable for the use in telecommunication network, central office optical cable system and premise fiber networks.

Typical type of our fiber panels are rack mounted, they are with optional different kinds of fiber optic adapters ports and pre-installed inner trays and accessories, optional pigtailed with different types

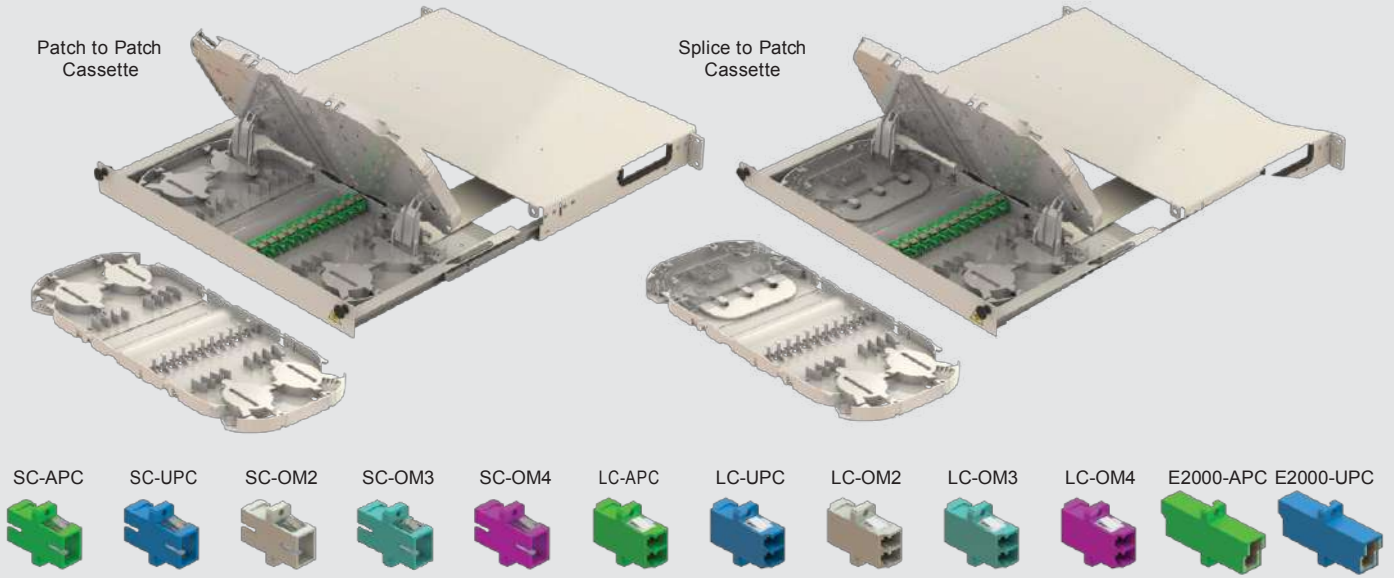

Features

- Clean: Both sides easily accessible for cleaning adapters
- Safe: Laser light oriented perpendicularly to the operator
- Accessible: Full front access at both sides of connection
- Visible: Patch cords do not hamper access or visibility of ports
- Easy reconnection within tray or shelf without uncontrolled overlenghts
- Manipulation of patch cords does not cause fiber loss
- Connectors in trays are more secured than in front facing patch panels
- Shelves are painted (powder-coated) in light grey (RAL 7035)

Dimensions

Chasis Size	19"
Shelf Unit Height	1U
Width (w/ mounting brackets)	481
Width (w/o mounting brackets)	443
Height	44
Depth	276

Model Coding

Patch to Patch	
Order Code	Description
UP-19-1U-PP-SM-SC-24	Single Mode, 24 SC/UPC
UP-19-1U-PP-SM-SA-24	Single Mode, 24 SC/APC
UP-19-1U-PP-M2-SC-24	Multi Mode(OM2), 24 SC/UPC
UP-19-1U-PP-M3-SC-24	Multi Mode(OM3), 24 SC/UPC
UP-19-1U-PP-M4-SC-24	Multi Mode(OM4), 24 SC/UPC
UP-19-1U-PP-SM-LC-48	Single Mode, 48 LC/UPC
UP-19-1U-PP-SM-LA-48	Single Mode, 48 LC/APC
UP-19-1U-PP-M2-LC-48	Multi Mode(OM2), 48 LC/UPC
UP-19-1U-PP-M3-LC-48	Multi Mode(OM3), 48 LC/UPC
UP-19-1U-PP-M4-LC-48	Multi Mode(OM4), 48 LC/UPC
UP-19-1U-PP-SM-E2-24	Single Mode, 24 E2000/UPC
UP-19-1U-PP-SM-EA-24	Single Mode, 24 E2000/APC

Splice to Patch	
Order Code	Description
UP-19-1U-SP-SM-SC-24	Single Mode, 24 SC/UPC
UP-19-1U-SP-SM-SA-24	Single Mode, 24 SC/APC
UP-19-1U-SP-M2-SC-24	Multi Mode(OM2), 24 SC/UPC
UP-19-1U-SP-M3-SC-24	Multi Mode(OM3), 24 SC/UPC
UP-19-1U-SP-M4-SC-24	Multi Mode(OM4), 24 SC/UPC
UP-19-1U-SP-SM-LC-48	Single Mode, 48 LC/UPC
UP-19-1U-SP-SM-LA-48	Single Mode, 48 LC/APC
UP-19-1U-SP-M2-LC-48	Multi Mode(OM2), 48 LC/UPC
UP-19-1U-SP-M3-LC-48	Multi Mode(OM3), 48 LC/UPC
UP-19-1U-SP-M4-LC-48	Multi Mode(OM4), 48 LC/UPC
UP-19-1U-SP-SM-E2-24	Single Mode, 24 E2000/UPC
UP-19-1U-SP-SM-EA-24	Single Mode, 24 E2000/APC

Fiber Management Shelves

19" PP/SP 2U Fiber Management Shelves

Fiber Management Shelves are used to terminate and distribute optical fiber cables, termination box is ranging from 12 ports to 96 ports. They are convenient equipment to organize and connect the fiber optic links. It is suitable for the use in telecommunication network, central office optical cable system and premise fiber networks.

Typical type of our fiber panels are rack mounted, they are with optional different kinds of fiber optic adapters ports and pre-installed inner trays and accessories, optional pigtailed with different types.

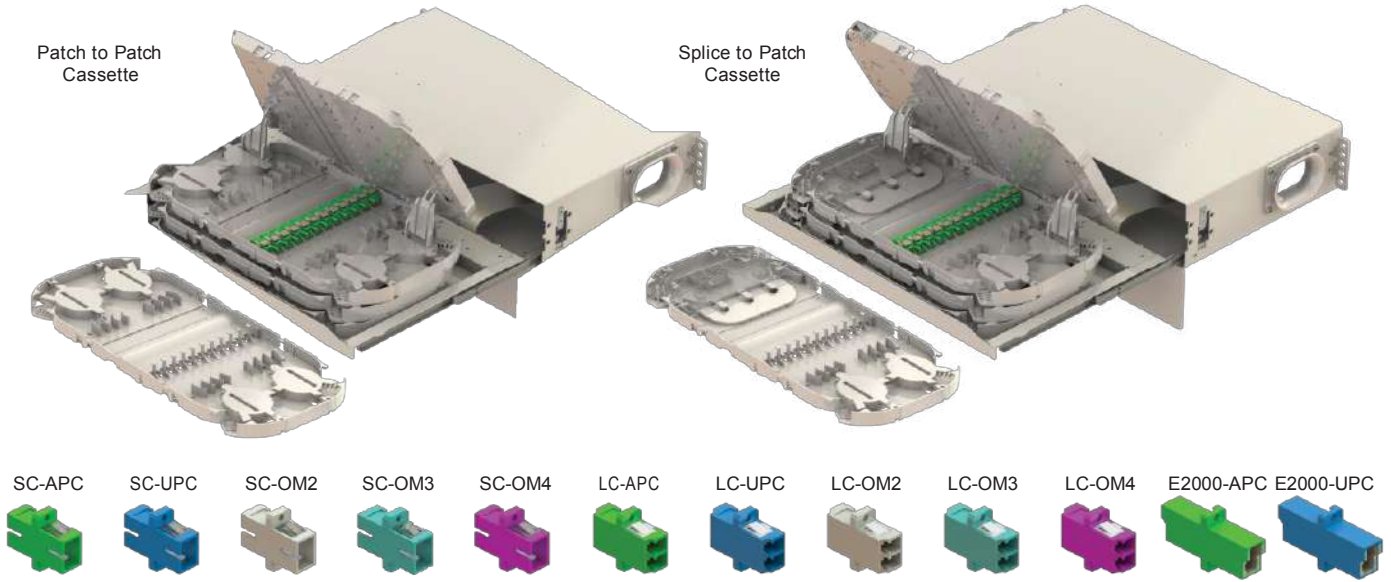

Features

- Clean: Both sides easily accessible for cleaning adapters
- Safe: Laser light oriented perpendicularly to the operator
- Accessible: Full front access at both sides of connection
- Visible: Patch cords do not hamper access or visibility of ports
- Easy reconnection within tray or shelf without uncontrolled overlenghts
- Manipulation of patch cords does not cause fiber loss
- Connectors in trays are more secured than in front facing patch panels
- Shelves are painted (powder-coated) in light grey (RAL 7035)

Dimensions

Chasis Size	19"
Shelf Unit Height	2U
Width (w/ mounting brackets)	481
Width (w/o mounting brackets)	443
Height	88
Depth	276

Model Coding

Patch to Patch	
Order Code	Description
UP-19-2U-PP-SM-SC-48	Single Mode, 48 SC/UPC
UP-19-2U-PP-SM-SA-48	Single Mode, 48 SC/APC
UP-19-2U-PP-M2-SC-48	Multi Mode(OM2), 48 SC/UPC
UP-19-2U-PP-M3-SC-48	Multi Mode(OM3), 48 SC/UPC
UP-19-2U-PP-M4-SC-48	Multi Mode(OM4), 48 SC/UPC
UP-19-2U-PP-SM-LC-96	Single Mode, 96 LC/UPC
UP-19-2U-PP-SM-LA-96	Single Mode, 96 LC/APC
UP-19-2U-PP-M2-LC-96	Multi Mode(OM2), 96 LC/UPC
UP-19-2U-PP-M3-LC-96	Multi Mode(OM3), 96 LC/UPC
UP-19-2U-PP-M4-LC-96	Multi Mode(OM4), 96 LC/UPC
UP-19-2U-PP-SM-E2-48	Single Mode, 48 E2000/UPC
UP-19-2U-PP-SM-EA-48	Single Mode, 48 E2000/APC

Splice to Patch	
Order Code	Description
UP-19-2U-SP-SM-SC-48	Single Mode, 48 SC/UPC
UP-19-2U-SP-SM-SA-48	Single Mode, 48 SC/APC
UP-19-2U-SP-M2-SC-48	Multi Mode(OM2), 48 SC/UPC
UP-19-2U-SP-M3-SC-48	Multi Mode(OM3), 48 SC/UPC
UP-19-2U-SP-M4-SC-48	Multi Mode(OM4), 48 SC/UPC
UP-19-2U-SP-SM-LC-96	Single Mode, 96 LC/UPC
UP-19-2U-SP-SM-LA-96	Single Mode, 96 LC/APC
UP-19-2U-SP-M2-LC-96	Multi Mode(OM2), 96 LC/UPC
UP-19-2U-SP-M3-LC-96	Multi Mode(OM3), 96 LC/UPC
UP-19-2U-SP-M4-LC-96	Multi Mode(OM4), 96 LC/UPC
UP-19-2U-SP-SM-E2-48	Single Mode, 48 E2000/UPC
UP-19-2U-SP-SM-EA-48	Single Mode, 48 E2000/APC

19" PP/SP 3U Fiber Management Shelves

Fiber Management Shelves are used to terminate and distribute optical fiber cables, termination box is ranging from 12 ports to 96 ports. They are convenient equipment to organize and connect the fiber optic links. It is suitable for the use in telecommunication network, central office optical cable system and premise fiber networks.

Typical type of our fiber panels are rack mounted, they are with optional different kinds of fiber optic adapters ports and pre-installed inner trays and accessories, optional pigtailed with different types.

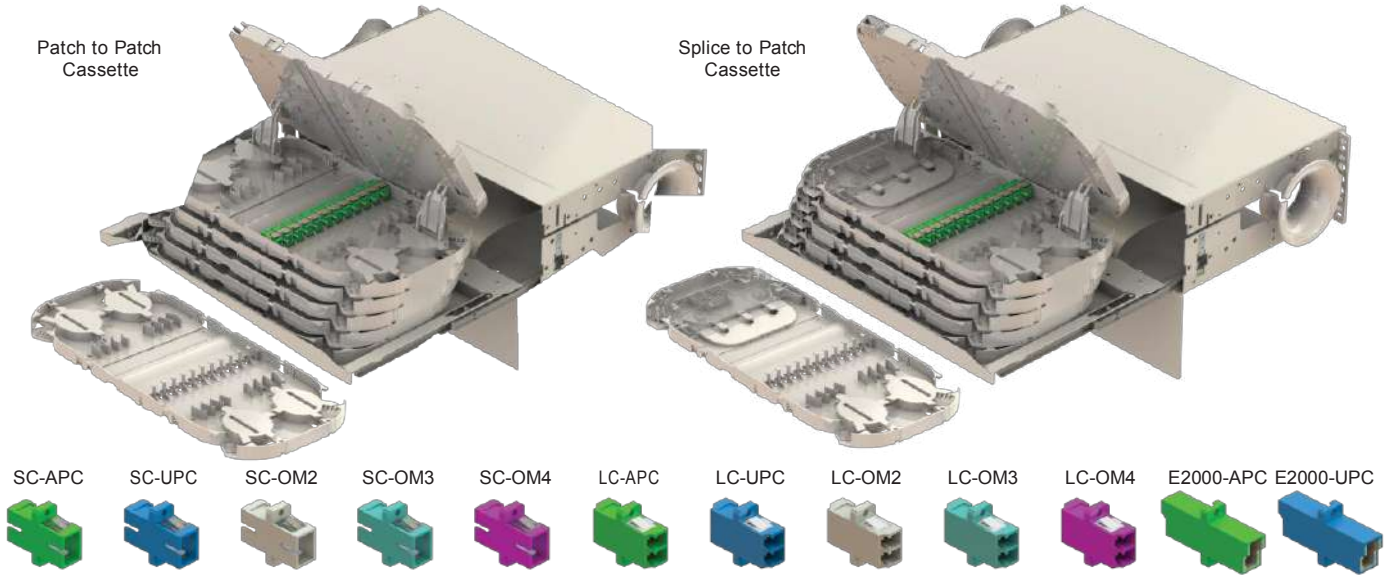

Features

- Clean: Both sides easily accessible for cleaning adapters
- Safe: Laser light oriented perpendicularly to the operator
- Accessible: Full front access at both sides of connection
- Visible: Patch cords do not hamper access or visibility of ports
- Easy reconnection within tray or shelf without uncontrolled overlengths
- Manipulation of patch cords does not cause fiber loss
- Connectors in trays are more secured than in front facing patch panels
- Shelves are painted (powder-coated) in light grey (RAL 7035)

Dimensions

Chassis Size	19"
Shelf Unit Height	3U
Width (w/ mounting brackets)	481
Width (w/o mounting brackets)	443
Height	122
Depth	276

Model Coding

Patch to Patch	
Order Code	Description
UP-19-3U-PP-SM-SC-72	Single Mode, 72 SC/UPC
UP-19-3U-PP-SM-SA-72	Single Mode, 72 SC/APC
UP-19-3U-PP-M2-SC-72	Multi Mode(OM2), 72 SC/UPC
UP-19-3U-PP-M3-SC-72	Multi Mode(OM3), 72 SC/UPC
UP-19-3U-PP-M4-SC-72	Multi Mode(OM4), 72 SC/UPC
UP-19-3U-PP-SM-LC-144	Single Mode, 144 LC/UPC
UP-19-3U-PP-SM-LA-144	Single Mode, 144 LC/APC
UP-19-3U-PP-M2-LC-144	Multi Mode(OM2), 144 LC/UPC
UP-19-3U-PP-M3-LC-144	Multi Mode(OM3), 144 LC/UPC
UP-19-3U-PP-M4-LC-144	Multi Mode(OM4), 144 LC/UPC
UP-19-3U-PP-SM-E2-72	Single Mode, 72 E2000/UPC
UP-19-3U-PP-SM-EA-72	Single Mode, 72 E2000/APC

Splice to Patch	
Order Code	Description
UP-19-3U-SP-SM-SC-72	Single Mode, 72 SC/UPC
UP-19-3U-SP-SM-SA-72	Single Mode, 72 SC/APC
UP-19-3U-SP-M2-SC-72	Multi Mode(OM2), 72 SC/UPC
UP-19-3U-SP-M3-SC-72	Multi Mode(OM3), 72 SC/UPC
UP-19-3U-SP-M4-SC-72	Multi Mode(OM4), 72 SC/UPC
UP-19-3U-SP-SM-LC-144	Single Mode, 144 LC/UPC
UP-19-3U-SP-SM-LA-144	Single Mode, 144 LC/APC
UP-19-3U-SP-M2-LC-144	Multi Mode(OM2), 144 LC/UPC
UP-19-3U-SP-M3-LC-144	Multi Mode(OM3), 144 LC/UPC
UP-19-3U-SP-M4-LC-144	Multi Mode(OM4), 144 LC/UPC
UP-19-3U-SP-SM-E2-72	Single Mode, 72 E2000/UPC
UP-19-3U-SP-SM-EA-72	Single Mode, 72 E2000/APC

Fiber Management Shelves

19" PP/SP 4U Fiber Management Shelves

Fiber Management Shelves are used to terminate and distribute optical fiber cables, termination box is ranging from 12 ports to 96 ports. They are convenient equipment to organize and connect the fiber optic links. It is suitable for the use in telecommunication network, central office optical cable system and premise fiber networks.

Typical type of our fiber panels are rack mounted, they are with optional different kinds of fiber optic adapters ports and pre-installed inner trays and accessories, optional pigtailed with different types.

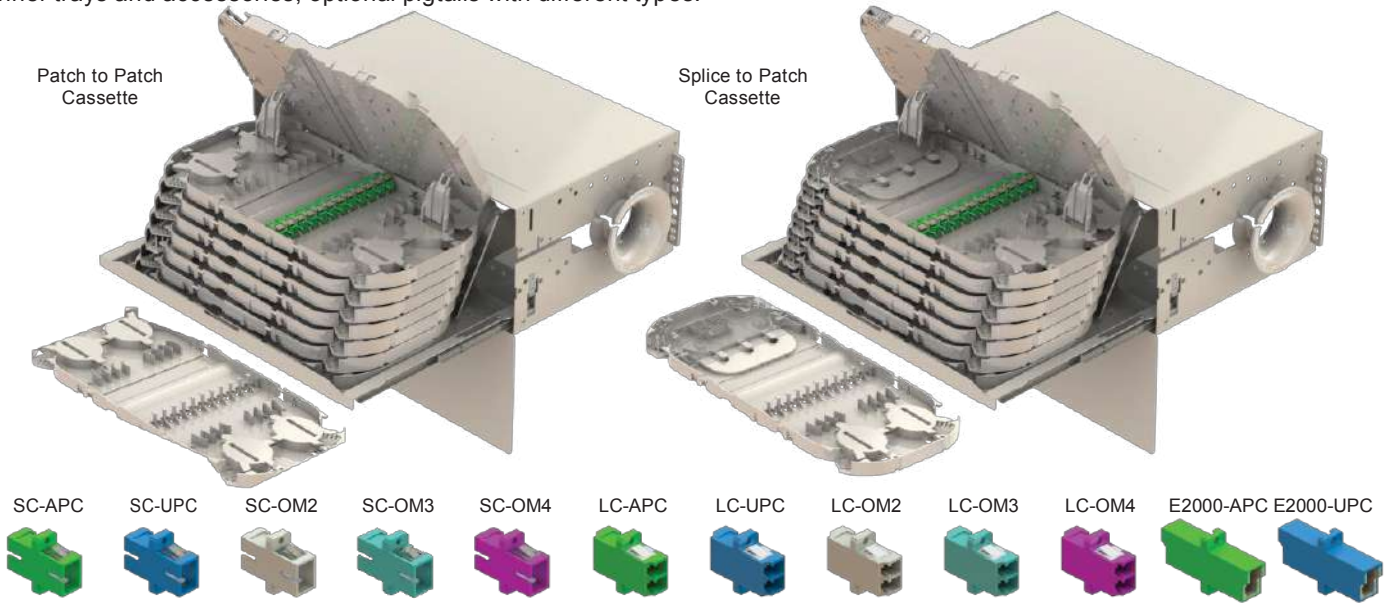

Features

- Clean: Both sides easily accessible for cleaning adapters
- Safe: Laser light oriented perpendicularly to the operator
- Accessible: Full front access at both sides of connection
- Visible: Patch cords do not hamper access or visibility of ports
- Easy reconnection within tray or shelf without uncontrolled overlengths
- Manipulation of patch cords does not cause fiber loss
- Connectors in trays are more secured than in front facing patch panels
- Shelves are painted (powder-coated) in light grey (RAL 7035)

Dimensions

Chassis Size	19"
Shelf Unit Height	4U
Width (w/ mounting brackets)	481
Width (w/o mounting brackets)	443
Height	168
Depth	276

Model Coding

Patch to Patch	
Order Code	Description
UP-19-4U-PP-SM-SC-96	Single Mode, 96 SC/UPC
UP-19-4U-PP-SM-SA-96	Single Mode, 96 SC/APC
UP-19-4U-PP-M2-SC-96	Multi Mode(OM2), 96 SC/UPC
UP-19-4U-PP-M3-SC-96	Multi Mode(OM3), 96 SC/UPC
UP-19-4U-PP-M4-SC-96	Multi Mode(OM4), 96 SC/UPC
UP-19-4U-PP-SM-LC-192	Single Mode, 192 LC/UPC
UP-19-4U-PP-SM-LA-192	Single Mode, 192 LC/APC
UP-19-4U-PP-M2-LC-192	Multi Mode(OM2), 192 LC/UPC
UP-19-4U-PP-M3-LC-192	Multi Mode(OM3), 192 LC/UPC
UP-19-4U-PP-M4-LC-192	Multi Mode(OM4), 192 LC/UPC
UP-19-4U-PP-SM-E2-96	Single Mode, 96 E2000/UPC
UP-19-4U-PP-SM-EA-96	Single Mode, 96 E2000/APC

Splice to Patch	
Order Code	Description
UP-19-4U-SP-SM-SC-96	Single Mode, 96 SC/UPC
UP-19-4U-SP-SM-SA-96	Single Mode, 96 SC/APC
UP-19-4U-SP-M2-SC-96	Multi Mode(OM2), 96 SC/UPC
UP-19-4U-SP-M3-SC-96	Multi Mode(OM3), 96 SC/UPC
UP-19-4U-SP-M4-SC-96	Multi Mode(OM4), 96 SC/UPC
UP-19-4U-SP-SM-LC-192	Single Mode, 192 LC/UPC
UP-19-4U-SP-SM-LA-192	Single Mode, 192 LC/APC
UP-19-4U-SP-M2-LC-192	Multi Mode(OM2), 192 LC/UPC
UP-19-4U-SP-M3-LC-192	Multi Mode(OM3), 192 LC/UPC
UP-19-4U-SP-M4-LC-192	Multi Mode(OM4), 192 LC/UPC
UP-19-4U-SP-SM-E2-96	Single Mode, 96 E2000/UPC
UP-19-4U-SP-SM-EA-96	Single Mode, 96 E2000/APC

21" PP/SP 3U Fiber Management Shelves

Fiber Management Shelves are used to terminate and distribute optical fiber cables, termination box is ranging from 12 ports to 96 ports. They are convenient equipment to organize and connect the fiber optic links. It is suitable for the use in telecommunication network, central office optical cable system and premise fiber networks.

Typical type of our fiber panels are rack mounted, they are with optional different kinds of fiber optic adapters ports and pre-installed inner trays and accessories, optional pigtailed with different types.

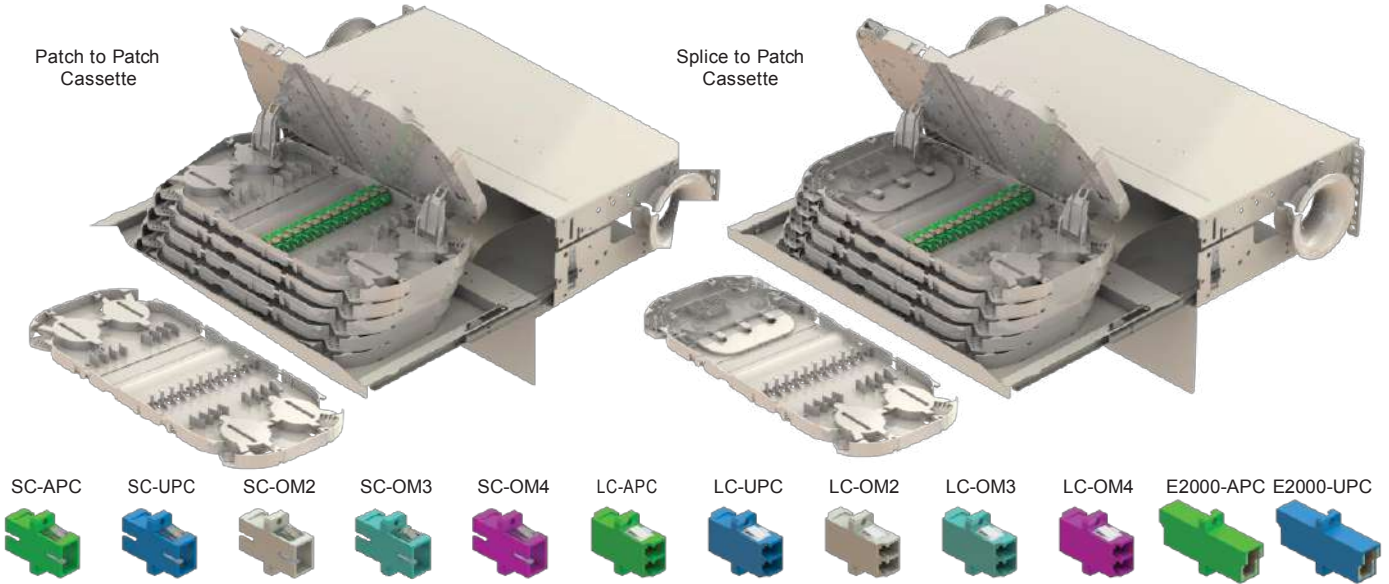

Features

- Clean: Both sides easily accessible for cleaning adapters
- Safe: Laser light oriented perpendicularly to the operator
- Accessible: Full front access at both sides of connection
- Visible: Patch cords do not hamper access or visibility of ports
- Easy reconnection within tray or shelf without uncontrolled overlengths
- Manipulation of patch cords does not cause fiber loss
- Connectors in trays are more secured than in front facing patch panels
- Shelves are painted (powder-coated) in light grey (RAL 7035)

Dimensions

Chassis Size	21"
Shelf Unit Height	3U
Width (w/ mounting brackets)	541
Width (w/o mounting brackets)	493
Height	122
Depth	276

Model Coding

Patch to Patch	
Order Code	Description
UP-21-3U-PP-SM-SC-72	Single Mode, 72 SC/UPC
UP-21-3U-PP-SM-SA-72	Single Mode, 72 SC/APC
UP-21-3U-PP-M2-SC-72	Multi Mode(OM2), 72 SC/UPC
UP-21-3U-PP-M3-SC-72	Multi Mode(OM3), 72 SC/UPC
UP-21-3U-PP-M4-SC-72	Multi Mode(OM4), 72 SC/UPC
UP-21-3U-PP-SM-LC-144	Single Mode, 144 LC/UPC
UP-21-3U-PP-SM-LA-144	Single Mode, 144 LC/APC
UP-21-3U-PP-M2-LC-144	Multi Mode(OM2), 144 LC/UPC
UP-21-3U-PP-M3-LC-144	Multi Mode(OM3), 144 LC/UPC
UP-21-3U-PP-M4-LC-144	Multi Mode(OM4), 144 LC/UPC
UP-21-3U-PP-SM-E2-72	Single Mode, 72 E2000/UPC
UP-21-3U-PP-SM-EA-72	Single Mode, 72 E2000/APC

Splice to Patch	
Order Code	Description
UP-21-3U-SP-SM-SC-72	Single Mode, 72 SC/UPC
UP-21-3U-SP-SM-SA-72	Single Mode, 72 SC/APC
UP-21-3U-SP-M2-SC-72	Multi Mode(OM2), 72 SC/UPC
UP-21-3U-SP-M3-SC-72	Multi Mode(OM3), 72 SC/UPC
UP-21-3U-SP-M4-SC-72	Multi Mode(OM4), 72 SC/UPC
UP-21-3U-SP-SM-LC-144	Single Mode, 144 LC/UPC
UP-21-3U-SP-SM-LA-144	Single Mode, 144 LC/APC
UP-21-3U-SP-M2-LC-144	Multi Mode(OM2), 144 LC/UPC
UP-21-3U-SP-M3-LC-144	Multi Mode(OM3), 144 LC/UPC
UP-21-3U-SP-M4-LC-144	Multi Mode(OM4), 144 LC/UPC
UP-21-3U-SP-SM-E2-72	Single Mode, 72 E2000/UPC
UP-21-3U-SP-SM-EA-72	Single Mode, 72 E2000/APC

Fiber Management Shelves

Dimensions & Accessories

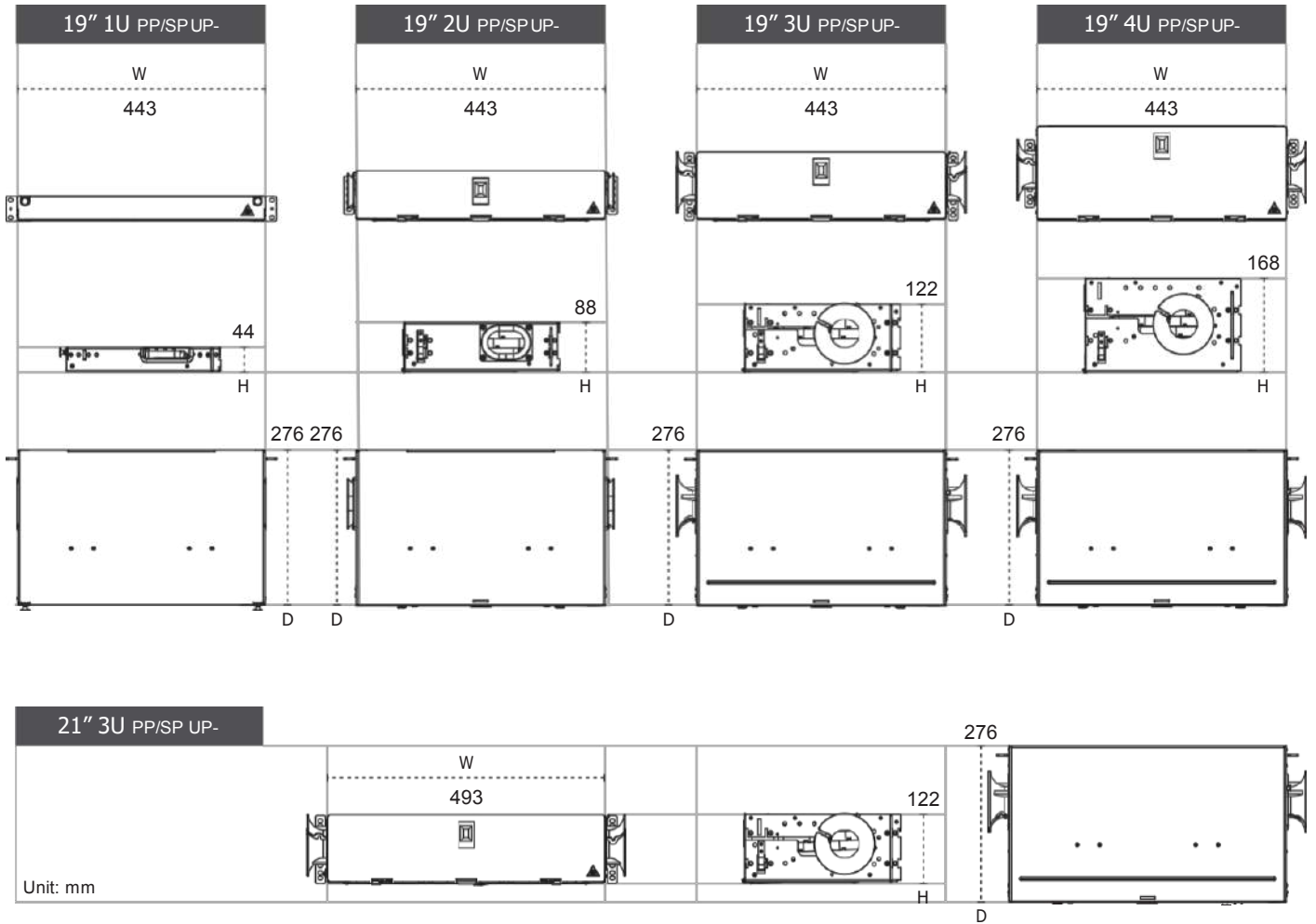

Accessories

1U (19" to 21") Extension Kit



2U (19" to 21") Extension Kit



3U / 4U (19" to 21") Extension Kit



Tel: UPCOM Telekomünikasyon Bilişim Teknolojileri San. Ve Tic. LTD. ŞTİ.

Yenişehir Mah. Cumhuriyet Bulv. No 12-1 D.81 A Blok Kurtköy PENDİK Istanbul Turkey

Vergi No: 8930472817 - Pendik V.D. - Mersis No: 0893047281700002

Tel: +902163262626 Fax: +902163262626 info@upcom.com.tr - www.upcom.com.tr

