

FOK



FOK Cable Blowing Machine provides an excellent flexibility and compact design to the users offering a complete solution. Capable of installing the cables Fiber optic cable and micro duct. In a range of Ø 9 to 22 mm diameter and duct outer diameter (OD) may vary 20mm to 50 mm. FOK Machine is engineered for blowing Fiber optic cables in preinstalled ducts. This multifunctional machine is easy to use for the installation of cables and micro-ducts by air and covers a wide range of cable diameters.

FOK Machine has a significant productivity and it considerably increases your labor's production capacity. A special and carefully designed pallet system assuring an excellent cable drip and decrease the damage risk. Clamping system adjust the cable outer diameter fluctuation/tolerance. In addition to that, its high-tech engineered design and structure improve blowing performance. Each and every part of machine are engineered and produced to meet and exceed the expectation of customer requirements.

FOK Machine is a Fiber optic cable blowing machine designed to blow cables into preinstalled telecommunication ducts and micro ducts by using of compressed air. Having 3 pallet options as 9-14mm, 14-18mm and 18-22mm to blow the cables having min 9mm to max. 22mm with a speed of 80m/min. Duct diameter can be in the range of 20 mm to 50 mm. Special pallet design will allow you to install your cables under muddy field conditions and Cable Blowing Power will not be decreased. You can set cable installing speed and direction with control valve.

A wisely designed exit box will supply highly productive leading for pressured air into telecom ducts. Quick air connection makes your business easier with an easy plug-in method. You can transfer lubricant oil onto pre-installed duct with the shock lubrication system to reduce friction between duct and cables. Two air motors will ensure to continuous high effective cable blowing power. You are capable of switching on or off the air entering into telecom ducts with guidance of valves. Festo Lubricant system takes off moisture of pressured air which comes from compressor and supplies continuous lubricate for air motors.

FOK

FOK CONTENT

CONSISTING OF

- 1set (2pcs) of Pallet (1)
- 1pcs Duct Lubricant System (2)
- 2pcs Air Motor (3)
- 1pcs Air Lubrication System (4)
- 1set Cable Aligning Parts (5)

WITH OUT

- Air Cooler
- Lubricant Oil
- Air Compressor

WITH

- 1pcs Operator Guide
- 1pcs Cable Inserts(7)
- 1set Duct Inserts(8)
- 1set Blue Nutring (9)
- 2m Black Rubber O-Ring (10)
- 1pcs Protected Wooden Case with holder (11)
- 1pcs Quick Insert Air Jack (12)
- 1set Tool Kit (13)
- 1pcs Box for plastic tools

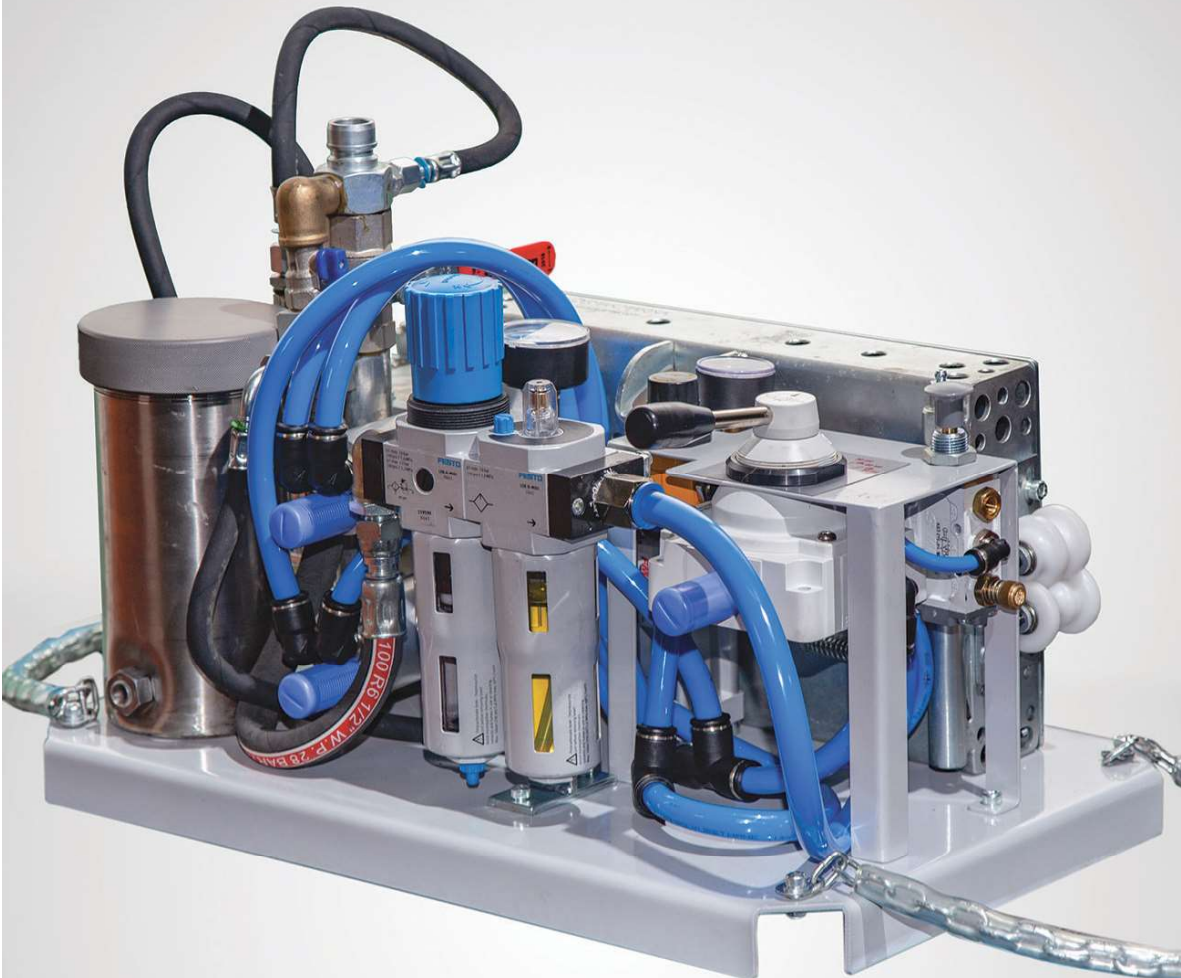

TECHNICAL DATA

FOK

Standard version	2pcs of pneumatic motor drive
Type	FOK
Cable dia. [mm]	9-22
Pallet Options (mm)	9-13 / 14-18 / 19-22
Duct OD [mm]	20-50
Drive unit	Pneumatic
Max. air consumption of 1pcs of motor [m3/min]	3m 3/ min (at 6 bar)
Torque Nm – Max. Power	8.5 Nm x 2 Pieces
Max. distance to blow at once (Cable Dia. 12mm – Duct Dia. 40mm) (m)	3000
Linear pressure on cable [N/cm]	0-101
Max. speed [m/min]	80
Max. air pressure [bar]	16
Max. water pressure [bar]	23
Dimension of apparatus with case l x w x h [mm]	380 x 610 x 440
Dimension of tools and accessories case l x w x h [mm]	380 x 610 x 440
Weight of machine [kg]	40
Total weight [kg]	49

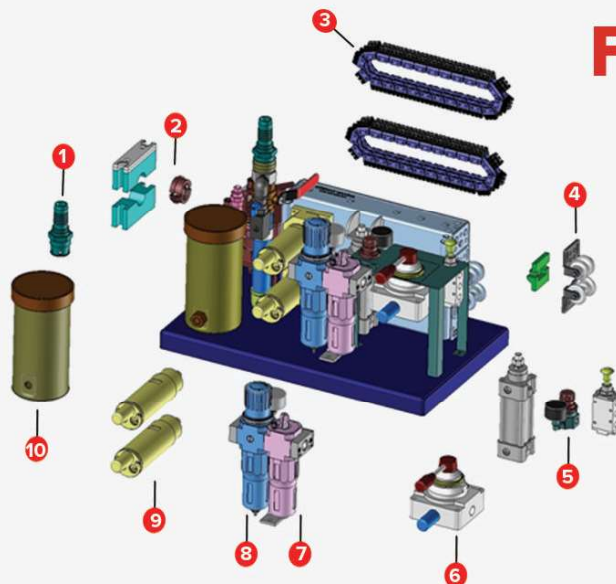

FOK MACHINE PARTS

Quick Pipe Connection **.1**

Easy Duct Connection **.2**

Rubber coated chain for pushing cable without skidding **.3**

Cable aligning parts to blow cable ahead **.4**

Pressure regulator with piston group to regulate pushing force on cable and to make up&down movement automatically **.5**

Direction control valve for pushing and pulling fiberoptic cable **.6**

Air lubricating unit to lubricate air motors during cable blowing **.7**

Pressure regulating unit to regulate air pressure on air motors **.8**

Two air motors pushing cable together **.9**

Duct lubrication unit to lubricate duct during cable blowing **.10**

FOK ACCESSORIES

COMPRESSOR CAPACITY RECOMMENDATION

Efficiency	10,5 m3/min
Working pressure	12bars

These are minimum compressor requirements. You may use higher capacity of compressor which can increase the effectiveness. You can overcome the handicap of improperly installed ducts.

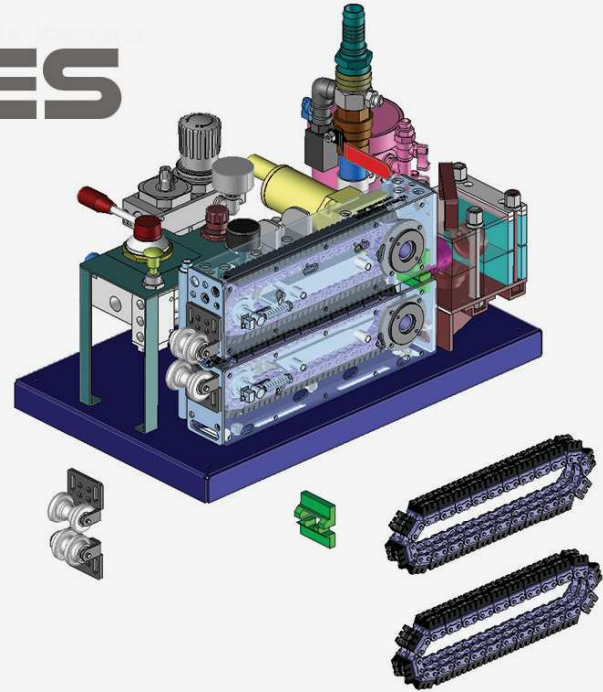

PALLET, CABLE ALIGNING AND DUCT OPTIONS

Pallet Set (mm)	Cable Aligning Tool & Nutrings (mm)	Duct Connection Tool (mm)
P1: 9-13	C1: 9-13	D: 20
P2: 14-18	C2: 14-18	D: 32
P3: 19-22	C3: 19-22	D: 40
		D: 50

ORDERING CODE

FOK	P1	C1	D32
Machine	Pallet Set	Cable Aligning Tool&Nutrings	Duct Connection Tool
FOK	P1	C1	D10
	P2	C2	D20
	P3	C3	D32
			D40
			D50
	MultipleOrdering	MultipleOrdering	MultipleOrdering
	P1+2+3	C1+2+3	D10+20+32

1 set of Pallet - 1 Set of Cable Aligning Tool + 1pcs Duct Connection Tool is included.