

HIDRO-FOK

Hidro-FOK Cable Blowing Machine is designed and properly engineered to blow Fiber Optic Cables and Micro tubes in HDPE ducts. This fiber optic cable blowing machine is equipped with Hydraulic motors. Hidro-FOK is working with hydraulic power unit. Micro Tubes can be blown any quantity of Micro Duct with the suitable pallet. Hydraulic motors are making Hidro-FOK the most powerful cable blowing machine among our machines. Hydraulic Motor are much stronger compared to Air Motor. Hidro-FOK machine is engineered to get highly effective and very safe method of fiber optic cable installation.

With its compact and dynamic outfit blowing machine, you can handle cables. Hydraulic type cable blower machine is an ideal choice for location our city (rural area) and also for long haul cable installation. A best designed machine which runs on hydraulic power, a heavy duty model hydraulic power pack. You need to change palette group and some parts to modify machine from tube to cable blowing machine or reverse. Hydraulic Power is the equipment to be used with Hidro-FOK Machine.

Capable of installing the Fiber Optic Cables & Micro Ducts -Fiber optic cable and microduct-. For cables Ø 9 to 25 mm and ducts OD 20 to 60 mm. Its high effectiveness significantly increases daily production. The pallet drive system ensures excellent cable grip without damage and the Pneumatic system absorbs cable diameter tolerances. In addition to that, its high tech engineered design and structure improve blowing performance. Each and every part of machine are engineered and produced to meet and exceed the expectation of customer requirements.

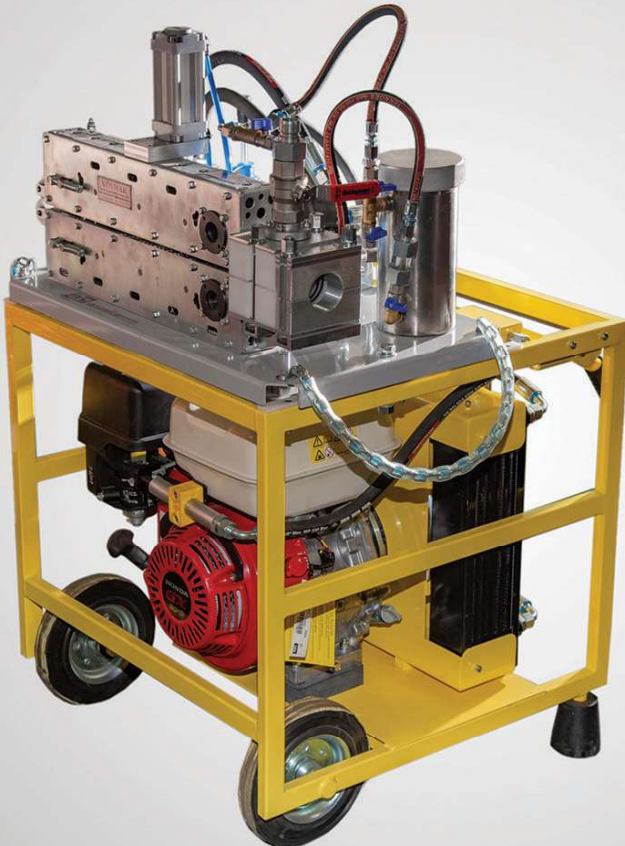

Hidro-FOK Machine is a Fiber optic cable blowing machine designed to blow cables into preinstalled telecommunication ducts and micro ducts by using of compressed air. Having 3 pallet options as 9-13mm, 14-18mm and 189-252mm to blow the cables having min 9mm to max. 19-25 mm with a speed of 80m/min. Special pallet design will allow you to install your cables under muddy field conditions and Cable Blowing Power will not be decreased. You can set cable installing speed and direction with hydraulic control valve. A wisely designed exit box will supply highly productive leading for pressured air into telecom ducts. Quick air connection makes your business easier with an easy plug in method. You can transfer lubricant oil onto pre-installed duct with the shock lubrication system to reduce friction between duct and cables. Your installing power never decrease with two hydraulic motors. You are capable of switching on or off the air entering into telecom ducts with guidance of valves.

HIDRO-FOK CONTENT

CONSISTING OF

- **1set** (2pcs) of Pallet
- **1pcs** Duct Lubricant System
- **2pcs** Hydraulic Motor
- **1pcs** Hydraulic Power Unit with Honda GX-270 Benzine Engine
- **1pcs** Exit Box

WITH OUT

- Air Cooler
- Lubricant Oil
- Air Compressor

WITH

- **1pcs** Operator Guide
- **1pcs** Cable Inserts
- **1set** Duct Inserts
- **1set** Blue Nutring
- **2m** Black Rubber O-Ring
- **1pcs** Protected Wooden Case with holder
- **1pcs** Quick Insert Air Jack
- **1set** Tool Kit
- **1pcs** Box for plastic tools

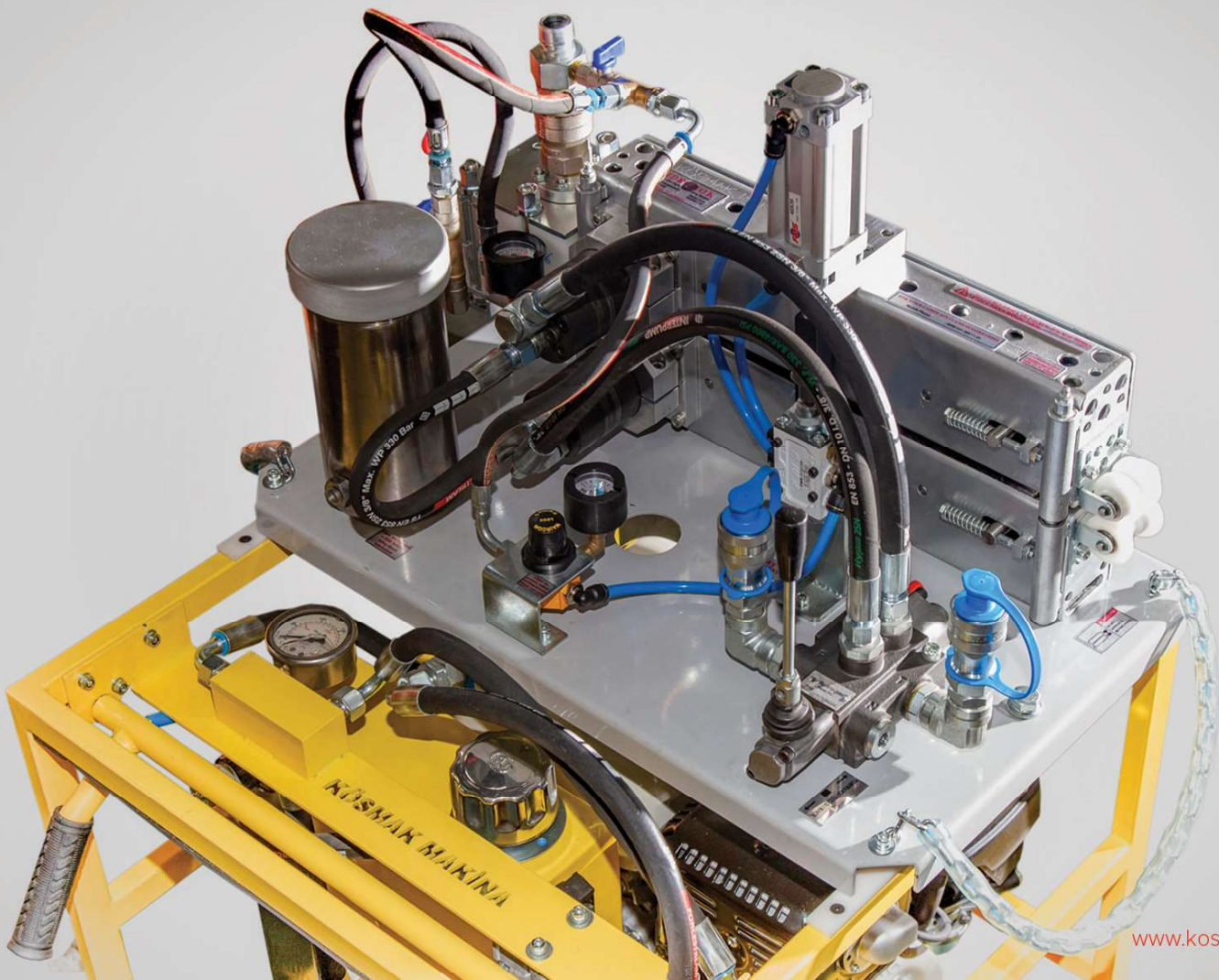

TECHNICAL DATA

HIDRO-FOK

Standard version	2pcs of hydraulic motor drive
Type	Hidro-FOK
Pallet Options (mm)	9-13 / 14-18 / 19-25
Cable dia. [mm]	9-25
Duct OD [mm]	20-60
Drive unit	Hydraulic Power Unit
Max. oil circulation of 1pcs of motor [liter/min]	20
Torque Nm – Max. Power	80
Distance to blow at once max. (Cable Dia. 12mm – Duct Dia. 40mm) (m)	3000
Linear pressure on cable [N/cm]	0-101
Max. speed [m/min]	80
Max. air pressure [bar]	16
Max. water pressure [bar]	23
Hydraulic Power Unit + Cable Blowing Machine	
Dimension of apparatus with case l x w x h [mm]	740 x 1200 x 740
Total weight [kg]	170

MACHINE PARTS

Hydraulic Fiber Blowing Machine & Hydraulic Power Unit

1. Easy Duct Connection.
2. Quick Pipe Connection.
3. Rubber coated chain for pushing cable without skidding.
4. Cable aligning parts.
5. Pressure regulator with piston group to regulate pushing force on cable and to make up&down movement automatically.
6. Direction control valve for pushing fiberoptic cable forward or backward
7. 2 hydraulic motors to push the cable.
8. Duct lubrication unit to lubricate duct during cable blowing

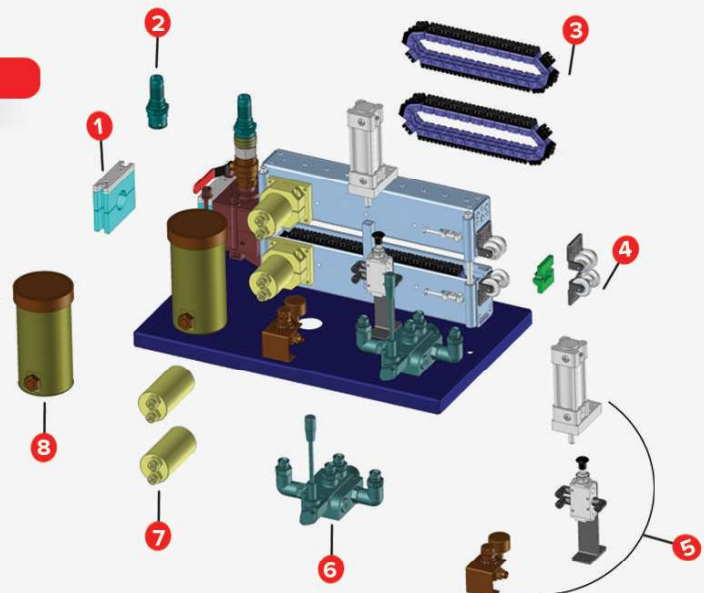

HIDRO-FOK



**Hydraulic Fiber
Blowing Machine**

**Hydraulic
Power Unit**

THE HYDRAULIC POWER UNIT PARTS



**Honda Engine
(Gasoline)**

Cooler Radiator

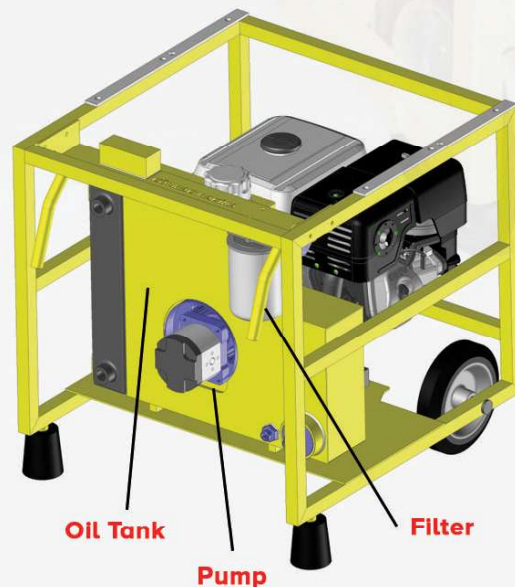

Oil Tank

Pump

Filter

HIDRO-FOK ACCESSORIES

COMPRESSOR CAPACITY RECOMMENDATION

Efficiency	10,5 m3/min
Working pressure	12 bar

These are minimum compressor requirements. You may use higher capacity of compressor which can increase the effectiveness. You can overcome the handicap of improperly installed ducts.

Duct Connection Tool

D1: Ø20 , D2: Ø32
D3: Ø40 , D4: Ø50

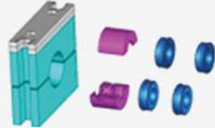

Cable Nuttings

N1: Ø9-Ø13
N2: Ø14-Ø18
N3: Ø19-Ø25

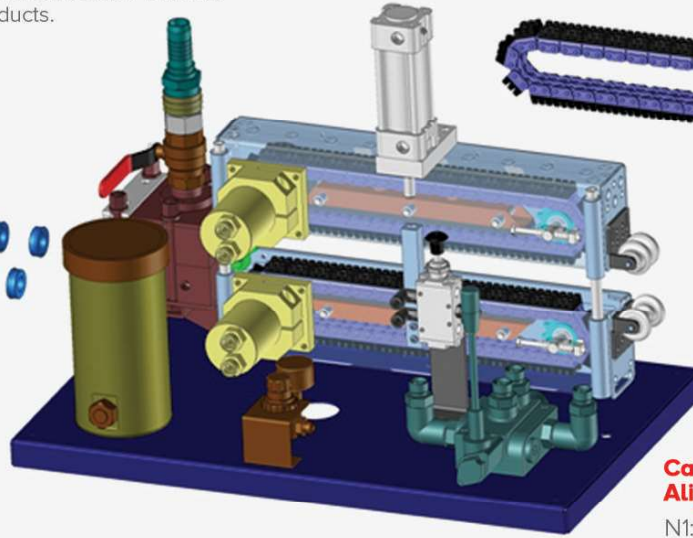

Pallet Set

P1: Ø9-Ø13
P2: Ø14-Ø18
P3: Ø19-Ø25

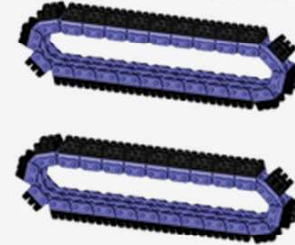

Cable Aligning Parts

N1: Ø9-Ø13
N2: Ø14-Ø18
N3: Ø19-Ø25

PALLET, CABLE ALIGNING AND DUCT OPTIONS

Pallet Set (mm)	Cable Aligning Tool (mm)	Duct Connection Tool (mm)
P1: 9-13	C1: 9-13	D1: 20
P2: 14-18	C2: 14-18	D2: 32
P3: 19-25	C3: 19-25	D3: 40
		D4: 50

ORDERING CODE

Hidro-FOK	P1	C1	D32
Machine	Pallet Set	Cable Aligning Tool	Duct Connection Tool
Hidro-FOK	P1	C1	D20
	P2	C2	D32
	P3	C3	D40
Multiple Ordering	Multiple Ordering	Multiple Ordering	D50
P1+2+3	C1+2+3	D10+20+32	

1 set of Pallet - 1 Set of Cable Aligning Tool + 1pcs Duct Connection Tool is included.